

TRAFFIC CRASH REPORT

*DENOTES MANDATORY FIELD FOR SUPPLEMENT REPORT

LOCAL REPORT NUMBER *

25-OPD-0352

<input type="checkbox"/> PHOTOS TAKEN <input type="checkbox"/> SECONDARY CRASH		<input checked="" type="checkbox"/> OH-2 <input type="checkbox"/> OH-1P <input checked="" type="checkbox"/> PRIVATE PROPERTY		LOCAL INFORMATION REPORTING AGENCY NAME * Oxford Police Department		NCIC * 00907		HIT/SKIP 1 - SOLVED 2 - UNSOLVED		NUMBER OF UNITS 2		UNIT IN ERROR 98 - ANIMAL 99 - UNKNOWN	
COUNTY* 9		LOCALITY* 1 - CITY 2 - VILLAGE 3 - TOWNSHIP 1		LOCATION: CITY, VILLAGE, TOWNSHIP* Oxford		CRASH DATE / TIME* 04/28/2025 22:10		CRASH SEVERITY 1 - FATAL 2 - SERIOUS INJURY SUSPECTED 3 - MINOR INJURY SUSPECTED 4 - INJURY POSSIBLE 5 - PROPERTY DAMAGE ONLY					
ROUTE TYPE LOCATION		ROUTE NUMBER PREFIX 1 - NORTH 2 - SOUTH 3 - EAST 4 - WEST 2		LOCATION ROAD NAME LOCUST		ROAD TYPE ST		LATITUDE DECIMAL DEGREES 39.504526		LONGITUDE DECIMAL DEGREES -84.749013			
ROUTE TYPE REFERENCE		ROUTE NUMBER PREFIX 1 - NORTH 2 - SOUTH 3 - EAST 4 - WEST		REFERENCE ROAD NAME (ROAD, MILEPOST, HOUSE #) 601 LOCUST		ROAD TYPE							
REFERENCE POINT 1 - INTERSECTION 2 - MILE POST 3 - HOUSE # 3		DIRECTION FROM REFERENCE 1 - NORTH 2 - SOUTH 3 - EAST 4 - WEST 2		ROUTE TYPE IR - INTERSTATE ROUTE (TP) US - FEDERAL US ROUTE SR - STATE ROUTE CR - NUMBERED COUNTY ROUTE TR - NUMBERED TOWNSHIP ROUTE		ROAD TYPE AL - ALLEY AV - AVENUE BL - BOULEVARD CR - CIRCLE CT - COURT DR - DRIVE HE - HEIGHTS		HW - HIGHWAY LA - LANE MP - MILEPOST OV - OVAL PK - PARKWAY PI - PIKE PL - PLACE		RD - ROAD SQ - SQUARE ST - STREET TE - TERRACE TL - TRAIL WA - WAY			
DISTANCE FROM REFERENCE 100.00		DISTANCE UNIT OF MEASURE 1 - MILES 2 - FEET 3 - YARDS 2		INTERSECTION RELATED <input type="checkbox"/> WITHIN INTERSECTION OR ON APPROACH <input type="checkbox"/> WITHIN INTERCHANGE AREA		ROADWAY <input type="checkbox"/> ROADWAY DIVIDED		NUMBER OF APPROACHES					
LOCATION OF FIRST HARMFUL EVENT 1 - ON ROADWAY 2 - ON SHOULDER 3 - IN MEDIAN 4 - ON ROADSIDE 5 - ON GORE 6 - OUTSIDE TRAFFIC WAY 7 - ON RAMP 8 - OFF RAMP 99				MANNER OF CRASH COLLISION/IMPACT 1 - NOT COLLISION BETWEEN TWO MOTOR VEHICLES IN TRANSPORT 2 - REAR-END 3 - HEAD-ON 4 - REAR-TO-REAR 5 - BACKING 6 - ANGLE 7 - SIDESWIPE, SAME DIRECTION 8 - SIDESWIPE, OPPOSITE DIRECTION 9 - OTHER / UNKNOWN 1				DIRECTION OF TRAVEL 1 - NORTH 2 - SOUTH 3 - EAST 4 - WEST		MEDIAN TYPE 1 - DIVIDED FLUSH MEDIAN (< 4 FEET) 2 - DIVIDED FLUSH MEDIAN (≥ 4 FEET) 3 - DIVIDED, DEPRESSED MEDIAN 4 - DIVIDED, RAISED MEDIAN (ANY TYPE) 9 - OTHER / UNKNOWN			
<input type="checkbox"/> WORK ZONE RELATED <input type="checkbox"/> WORKERS PRESENT <input type="checkbox"/> LAW ENFORCEMENT PRESENT <input type="checkbox"/> ACTIVE SCHOOL ZONE		WORK ZONE TYPE 1 - LANE CLOSURE 2 - LANE SHIFT/ CROSSOVER 3 - WORK ON SHOULDER OR MEDIAN 4 - INTERMITTENT OR MOVING WORK 5 - OTHER		LOCATION OF CRASH IN WORK ZONE 1 - BEFORE THE 1ST WORK ZONE WARNING SIGN 2 - ADVANCE WARNING AREA 3 - TRANSITION AREA 4 - ACTIVITY AREA 5 - TERMINATION AREA		CONTOUR 1 1 - STRAIGHT LEVEL 2 - STRAIGHT GRADE 3 - CURVE LEVEL 4 - CURVE GRADE 9 - OTHER / UNKNOWN		CONDITIONS 1 1 - DRY 2 - WET 3 - SNOW 4 - ICE 5 - SAND, MUD, DIRT, OIL, GRAVEL 6 - WATER (STANDING, MOVING) 7 - SLUSH 9 - OTHER / UNKNOWN		SURFACE 2 1 - CONCRETE 2 - BLACKTOP, BITUMINOUS, ASPHALT 3 - BRICK/BLOCK 4 - SLAG, GRAVEL, STONE 5 - DIRT 9 - OTHER / UNKNOWN			
LIGHT CONDITION 1 - DAYLIGHT 2 - DAWN/DUSK 3 - DARK - LIGHTED ROADWAY 4 - DARK - ROADWAY NOT LIGHTED 5 - DARK - UNKNOWN ROADWAY LIGHTING 9 - OTHER / UNKNOWN 3				WEATHER 1 - CLEAR 2 - CLOUDY 3 - FOG, SMOG, SMOKE 4 - RAIN 5 - SLEET, HAIL 6 - SNOW 7 - SEVERE CROSSWINDS 8 - BLOWING SAND, SOIL, DIRT, SNOW 9 - FREEZING RAIN OR FREEZING DRIZZLE 99 - OTHER / UNKNOWN 1				NARRATIVE Unit 1 turned into the parking lot 601 S Locust St and attempted to pull into an angled parking space. Unit 1 turned too wide and struck the rear end of Unit 2, which was parked and unoccupied in the second angled space next to where Unit 1 was attempting to park. Unit 1's passenger side front bumper was bent, paint scratched, and had red paint transferred onto the panel. Unit 2 received minor paint damage and had white paint transferred onto the driver side rear bumper and rear wheel well panel. Unit 1 then reversed out of the parking space, speed off out of the parking lot, and parked across the street at T.J. Maxx. Unit 1 driver did not leave information for Unit 2 and never made contact with the Unit 2 owner. Unit 1 was towed for investigation and hours later, Unit 1 driver flagged an officer down to inquire about their missing vehicle. Unit 1 driver admitted to hitting Unit 2, but stated they did not believe they damaged Unit 2, so they did not feel like they needed to exchange info as they themselves did not want to report the incident to insurance. Unit 1 driver was issued a citation for Stopping after an accident on other than public roads.					
CRASH REPORTED DATE / TIME 04/28/2025 22:22				DISPATCH DATE / TIME 04/28/2025 22:24		ARRIVAL DATE / TIME 04/28/2025 22:29		SCENE CLEARED DATE / TIME 04/28/2025 23:23		REPORT TAKEN BY <input checked="" type="checkbox"/> POLICE AGENCY <input type="checkbox"/> MOTORIST			
TOTAL TIME ROADWAY CLOSED 0		OTHER INVESTIGATION TIME 30		TOTAL MINUTES 89		OFFICER'S NAME* Combs, Grant		CHECKED BY OFFICER'S NAME* King, David		<input type="checkbox"/> SUPPLEMENT (CORRECTION OR ADDITION TO AN EXISTING REPORT SENT TO ODPS)			
OFFICER'S BADGE NUMBER* 40				CHECKED BY OFFICER'S BADGE NUMBER* 30									

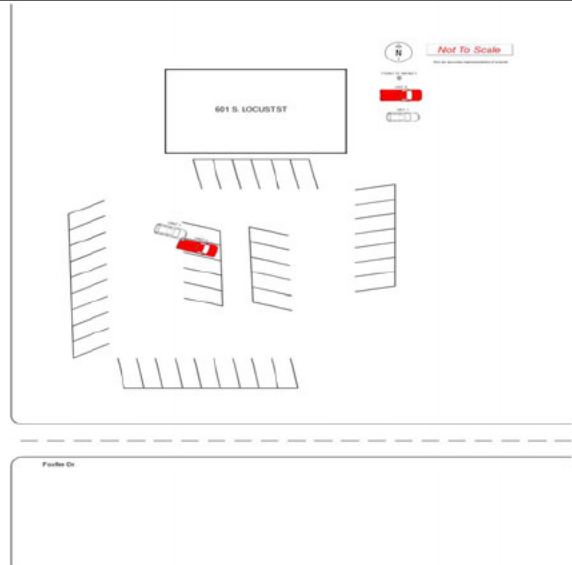

UNIT # 1	OWNER NAME: LAST, FIRST, MIDDLE (<input type="checkbox"/> SAME AS DRIVER) BRUNS, ANNA, L	OWNER PHONE: INCLUDE AREA CODE (<input type="checkbox"/> SAME AS DRIVER)
OWNER ADDRESS: STREET, CITY, STATE, ZIP (<input type="checkbox"/> SAME AS DRIVER) 9106 RAYMODN RD , BROOKVILLE, IN, 470128116		
COMMERCIAL CARRIER: NAME, ADDRESS, CITY, STATE, ZIP		COMMERCIAL CARRIER PHONE: INCLUDE AREA CODE

DAMAGE

DAMAGE SCALE

1 - NONE 3 - FUNCTIONAL DAMAGE
 2 - MINOR DAMAGE 4 - DISABLING DAMAGE
 9 - UNKNOWN

LP STATE IN	LICENSE PLATE # TRM232	VEHICLE IDENTIFICATION # 5UXFF0C54ALT84265	VEHICLE YEAR 2010	VEHICLE MAKE BMW
<input checked="" type="checkbox"/> INSURANCE VERIFIED	INSURANCE COMPANY WESTERN RESERVE MUTUAL	INSURANCE POLICY # WPV1301241998	COLOR WHI	VEHICLE MODEL X5
<input type="checkbox"/> COMMERCIAL <input type="checkbox"/> GOVERNMENT <input type="checkbox"/> IN EMERGENCY RESPONSE	TYPE OF USE	US DOT #	TOWED BY: COMPANY NAME CARSTAR	
<input type="checkbox"/> INTERLOCK DEVICE EQUIPPED	<input checked="" type="checkbox"/> HIT/SKIP UNIT	# OCCUPANTS 1	HAZARDOUS MATERIAL CLASS # PLACARD ID #	
VEHICLE WEIGHT GVWR/GCWR 1 - ≤ 10K LBS. 2 - 10.001 - 26K LBS. 3 - > 26K LBS.		VEHICLE TYPE		
1 - PASSENGER CAR 6 - VAN (9-15 SEATS) 12 - GOLF CART 18 - LIMO (LIVERY VEHICLE) 23 - PEDESTRIAN/SKATER 2 - PASSENGER VAN (MINIVAN) 7 - MOTORCYCLE 2-WHEELED 13 - SNOWMOBILE 19 - BUS (16+ PASSENGERS) 24 - WHEELCHAIR (ANY TYPE) 3 - SPORT UTILITY VEHICLE 8 - MOTORCYCLE 3-WHEELED 14 - SINGLE UNIT TRUCK 20 - OTHER VEHICLE 25 - OTHER NON-MOTORIST 4 - PICK UP 9 - AUTOCYCLE 15 - SEMI-TRACTOR 21 - HEAVY EQUIPMENT 26 - BICYCLE 5 - CARGO VAN 10 - MOPED OR MOTORIZED BICYCLE 16 - FARM EQUIPMENT 22 - ANIMAL WITH RIDER OR ANIMAL-DRAWN VEHICLE 27 - TRAIN 11 - ALL TERRAIN VEHICLE (ATV/UTV) 17 - MOTORHOME 99 - UNKNOWN OR HIT/SKIP		# of TRAILING UNITS 0		
WAS VEHICLE OPERATING IN AUTONOMOUS MODE WHEN CRASH OCCURRED?				
1 - YES 2 - NO 9 - OTHER / UNKNOWN <input checked="" type="checkbox"/> 2		0 - NO AUTOMATION 3 - CONDITIONAL AUTOMATION 9 - OTHER/UNKNOWN 1 - DRIVER ASSISTANCE 4 - HIGH AUTOMATION AUTONOMOUS 2 - PARTIAL AUTOMATION 5 - FULL AUTOMATION		
SPECIAL FUNCTION				
1 - NONE 6 - BUS - CHARTER/TOUR 11 - FIRE 16 - FARM 21 - MAIL CARRIER 2 - TAXI 7 - BUS - INTERCITY 12 - MILITARY 17 - MOWING 99 - OTHER / UNKNOWN 3 - ELECTRONIC RIDE SHARING 8 - BUS - SHUTTLE 13 - POLICE 18 - SNOW REMOVAL 4 - SCHOOL TRANSPORT 9 - BUS - OTHER 14 - PUBLIC UTILITY 19 - TOWING 5 - BUS - TRANSIT/COMMUTER 10 - AMBULANCE 15 - CONSTRUCTION EQUIP. 20 - SAFETY SERVICE PATROL				
CARGO BODY TYPE				
1 - NO CARGO BODY TYPE / NOT APPLICABLE 4 - LOGGING 7 - GRAIN/CHIPS/GRAVEL 11 - DUMP 99 - OTHER / UNKNOWN 2 - BUS 5 - INTERMODAL CONTAINER CHASSIS 8 - POLE 12 - CONCRETE MIXER 3 - VEHICLE TOWING ANOTHER MOTOR VEHICLE 6 - CARGOVAN /ENCLOSED BOX 9 - CARGO TANK 13 - AUTO TRANSPORTER 10 - FLAT BED 14 - GARBAGE/REFUSE				
VEHICLE DEFECTS				
1 - TURN SIGNALS 4 - BRAKES 7 - WORN OR SLICK TIRES 9 - MOTOR TROUBLE 99 - OTHER / UNKNOWN 2 - HEAD LAMPS 5 - STEERING 8 - TRAILER EQUIPMENT DEFECTIVE 10 - DISABLED FROM PRIOR ACCIDENT 3 - TAIL LAMPS 6 - TIRE BLOWOUT				

DAMAGED AREA(S)
INDICATE ALL THAT APPLY

NO DAMAGE [0] **UNDERCARRIAGE** [14]
 TOP [13] **ALL AREAS** [15]
 UNIT NOT AT SCENE [16]

NON-MOTORIST LOCATION	1 - INTERSECTION - MARKED CROSSWALK	4 - MIDBLOCK - MARKED CROSSWALK	7 - SHOULDER/ROADSIDE	10 - DRIVEWAY ACCESS	99 - OTHER / UNKNOWN
ACTION	1 - NON-CONTACT	1 - STRAIGHT AHEAD	9 - LEAVING TRAFFIC LANE	15 - WALKING, RUNNING, JOGGING, PLAYING	21 - STANDING OUTSIDE DISABLED VEHICLE
PRE-CRASH ACTIONS	2 - NON-COLLISION	2 - BACKING	10 - PARKED	16 - WORKING	99 - OTHER / UNKNOWN
CONTRIBUTING CIRCUMSTANCES	3 - STRIKING	3 - CHANGING LANES	11 - SLOWING OR STOPPED IN TRAFFIC	17 - PUSHING VEHICLE	
SEQUENCE OF EVENTS	4 - STRUCK	4 - OVERTAKING/PASSING	12 - DRIVERLESS	18 - APPROACHING OR LEAVING VEHICLE	
	5 - BOTH STRIKING & STRUCK	5 - MAKING RIGHT TURN	13 - NEGOTIATING A CURVE	19 - STANDING	
	6 - IMPROPER TURN	6 - MAKING LEFT TURN	14 - ENTERING OR CROSSING SPECIFIED LOCATION	20 - OTHER NON-MOTORIST	
	7 - LEFT OF CENTER	7 - MAKING U-TURN			
		8 - ENTERING TRAFFIC LANE			
		8 - FOLLOWING TOO CLOSE /ACDA			
		9 - IMPROPER LANE CHANGE			
		10 - IMPROPER PASSING			
		11 - DROVE OFF ROAD			
		12 - IMPROPER BACKING			
		13 - IMPROPER START FROM A PARKED POSITION			
		14 - STOPPED OR PARKED ILLEGALLY			
		15 - SWERVING TO AVOID			
		16 - WRONG WAY			
		17 - VISION OBSTRUCTION			
		18 - OPERATING DEFECTIVE EQUIPMENT			
		19 - LOAD SHIFTING /FALLING/SPILLING			
		20 - IMPROPER CROSSING			
		21 - LYING IN ROADWAY			
		22 - NOT DISCERNIBLE			
		23 - OPENING DOOR INTO ROADWAY			
		24 - OTHER IMPROPER ACTION			

INITIAL POINT OF CONTACT

0 - NO DAMAGE 14 - UNDERCARRIAGE
 1 - 12 - REFER TO UNIT DIAGRAM 15 - VEHICLE NOT AT SCENE
 99 - UNKNOWN
 13 - TOP

EVENTS (6)	1 - OVERTURN/ROLLOVER	7 - SEPARATION OF UNITS	12 - DOWNHILL RUNAWAY	19 - ANIMAL - OTHER	23 - STRUCK BY FALLING, SHIFTING CARGO OR ANYTHING SET IN MOTION BY A MOTOR VEHICLE
	2 - FIRE/EXPLOSION	8 - RAN OFF ROAD RIGHT	13 - OTHER NON-COLLISION	20 - MOTOR VEHICLE IN TRANSPORT	24 - OTHER MOVABLE OBJECT
	3 - IMMERSION	9 - RAN OFF ROAD LEFT	14 - PEDESTRIAN	21 - PARKED MOTOR VEHICLE	
	4 - JACKKNIFE	10 - CROSS MEDIAN	15 - PEDALCYCLE	22 - WORK ZONE MAINTENANCE EQUIPMENT	
	5 - CARGO / EQUIPMENT LOSS OR SHIFT	11 - CROSS CENTERLINE - OPPOSITE DIRECTION OF TRAVEL	16 - RAILWAY VEHICLE		
	6 - EQUIPMENT FAILURE		17 - ANIMAL - FARM		
			18 - ANIMAL - DEER		
			38 - OVERHEAD SIGN POST		
			39 - LIGHT / LUMINARIES SUPPORT		
			40 - UTILITY POLE		
			41 - OTHER POST, POLE OR SUPPORT		
			42 - CULVERT		
			43 - CURB		
			44 - DITCH		
			45 - EMBANKMENT		
			46 - FENCE		
			47 - MAILBOX		
			48 - TREE		
			49 - FIRE HYDRANT		
			50 - WORK ZONE MAINTENANCE EQUIPMENT		
			51 - WALL		
			52 - BUILDING		
			53 - TUNNEL		
			54 - OTHER FIXED OBJECT		
			99 - OTHER / UNKNOWN		

COLLISION WITH FIXED OBJECT - STRUCK

SEQUENCE OF EVENTS

1 - 21 **FIRST HARMFUL EVENT**

1 **MOST HARMFUL EVENT**

TRAFFIC

TRAFFICWAY FLOW
1 - ONE-WAY
2 - TWO-WAY
 1

TRAFFIC CONTROL
1 - ROUNDABOUT 4 - STOP SIGN
2 - SIGNAL 5 - YIELD SIGN
3 - FLASHER 6 - NO CONTROL
 6

OF THROUGH LANES ON ROAD
 1

RAIL GRADE CROSSING
1 - NOT INVOLVED
2 - INVOLVED-ACTIVE CROSSING
3 - INVOLVED-PASSIVE CROSSING
 1

UNIT / NON-MOTORIST DIRECTION

FROM TO

1 - NORTH 5 - NORTHEAST
2 - SOUTH 6 - NORTHWEST
3 - EAST 7 - SOUTHEAST
4 - WEST 8 - SOUTHWEST
9 - OTHER / UNKNOWN

UNIT SPEED

POSTED SPEED

DETECTED SPEED
1 - STATED / ESTIMATED SPEED
 3 2 - CALCULATED / EDR
3 - UNDETERMINED

OWNER

UNIT # 2 OWNER NAME: LAST, FIRST, MIDDLE (SAME AS DRIVER)
SMITH, PHILLIP, R

OWNER ADDRESS: STREET, CITY, STATE, ZIP (SAME AS DRIVER)
5349 HILLCREST DR , OXFORD, OH, 450561446

COMMERCIAL CARRIER: NAME, ADDRESS, CITY, STATE, ZIP
COMMERCIAL CARRIER PHONE: INCLUDE AREA CODE

VEHICLE

LP STATE OH LICENSE PLATE # KJY6662 VEHICLE IDENTIFICATION # 1FTPX02574KDD5521 VEHICLE YEAR 2004 VEHICLE MAKE FORD

INSURANCE VERIFIED INSURANCE COMPANY ALLSTATE INSURANCE POLICY # 966976778 COLOR RED VEHICLE MODEL F-150

COMMERCIAL GOVERNMENT IN EMERGENCY RESPONSE TYPE OF USE

INTERLOCK DEVICE EQUIPPED HIT/SKIP UNIT # OCCUPANTS 0 VEHICLE WEIGHT GVWR/GCWR 1 TOWED BY: COMPANY NAME

MATERIAL RELEASED PLACARD CLASS # PLACARD ID #

UNIT TYPE 4

OF TRAILING UNITS 0

1 - PASSENGER CAR 6 - VAN (9-15 SEATS) 12 - GOLF CART 18 - LIMO (LIVERY VEHICLE) 23 - PEDESTRIAN/SKATER
2 - PASSENGER VAN (MINIVAN) 7 - MOTORCYCLE 2-WHEELED 13 - SNOWMOBILE 19 - BUS (16+ PASSENGERS) 24 - WHEELCHAIR (ANY TYPE)
3 - SPORT UTILITY VEHICLE 8 - MOTORCYCLE 3-WHEELED 14 - SINGLE UNIT TRUCK 20 - OTHER VEHICLE 25 - OTHER NON-MOTORIST
4 - PICK UP 9 - AUTOCYCLE 10 - MOPED OR MOTORIZED BICYCLE 15 - SEMI-TRACTOR 21 - HEAVY EQUIPMENT 26 - BICYCLE
5 - CARGO VAN 11 - ALL TERRAIN VEHICLE (ATV/UTV) 16 - FARM EQUIPMENT 22 - ANIMAL WITH RIDER OR ANIMAL-DRAWN VEHICLE 99 - UNKNOWN OR HIT/SKIP

WAS VEHICLE OPERATING IN AUTONOMOUS MODE WHEN CRASH OCCURRED? 2

1 - YES 2 - NO 9 - OTHER / UNKNOWN

AUTONOMOUS MODE LEVEL 0

0 - NO AUTOMATION 1 - DRIVER ASSISTANCE 2 - PARTIAL AUTOMATION 3 - CONDITIONAL AUTOMATION 4 - HIGH AUTOMATION 5 - FULL AUTOMATION 9 - OTHER/UNKNOWN

SPECIAL FUNCTION 1

1 - NONE 2 - TAXI 3 - ELECTRONIC RIDE SHARING 4 - SCHOOL TRANSPORT 5 - BUS - TRANSIT/COMMUTER

6 - BUS - CHARTER/TOUR 7 - BUS - INTERCITY 8 - BUS - SHUTTLE 9 - BUS - OTHER 10 - AMBULANCE

11 - FIRE 12 - MILITARY 13 - POLICE 14 - PUBLIC UTILITY 15 - CONSTRUCTION EQUIP.

16 - FARM 17 - MOWING 18 - SNOW REMOVAL 19 - TOWING 20 - SAFETY SERVICE PATROL

21 - MAIL CARRIER 99 - OTHER / UNKNOWN

CARGO BODY TYPE 99

1 - NO CARGO BODY TYPE / NOT APPLICABLE 2 - BUS 3 - VEHICLE TOWING ANOTHER MOTOR VEHICLE

4 - LOGGING 5 - INTERMODAL CONTAINER CHASSIS 6 - CARGOVAN /ENCLOSED BOX

7 - GRAIN/CHIPS/GRAVEL 8 - POLE 9 - CARGO TANK 10 - FLAT BED

11 - DUMP 12 - CONCRETE MIXER 13 - AUTO TRANSPORTER 14 - GARBAGE/REFUSE

99 - OTHER / UNKNOWN

VEHICLE DEFECTS 99

1 - TURN SIGNALS 2 - HEAD LAMPS 3 - TAIL LAMPS

4 - BRAKES 5 - STEERING 6 - TIRE BLOWOUT

7 - WORN OR SLICK TIRES 8 - TRAILER EQUIPMENT DEFECTIVE

9 - MOTOR TROUBLE 10 - DISABLED FROM PRIOR ACCIDENT

99 - OTHER / UNKNOWN

NON-MOTORIST LOCATION 1

1 - INTERSECTION - MARKED CROSSWALK 2 - INTERSECTION - UNMARKED CROSSWALK 3 - INTERSECTION - OTHER

4 - MIDBLOCK - MARKED CROSSWALK 5 - TRAVEL LANE - OTHER LOCATION 6 - BICYCLE LANE

7 - SHOULDER/ROADSIDE 8 - SIDEWALK 9 - MEDIAN/CROSSING ISLAND

10 - DRIVEWAY ACCESS 11 - SHARED USE PATHS OR TRAILS 12 - FIRST RESPONDER AT INCIDENT SCENE

99 - OTHER / UNKNOWN

ACTION 4

1 - NON-CONTACT 2 - NON-COLLISION 3 - STRIKING 4 - STRUCK 5 - BOTH STRIKING & STRUCK 9 - OTHER / UNKNOWN

PRE-CRASH ACTIONS 10

1 - STRAIGHT AHEAD 2 - BACKING 3 - CHANGING LANES 4 - OVERTAKING/PASSING 5 - MAKING RIGHT TURN 6 - MAKING LEFT TURN 7 - MAKING U-TURN 8 - ENTERING TRAFFIC LANE

9 - LEAVING TRAFFIC LANE 10 - PARKED 11 - SLOWING OR STOPPED IN TRAFFIC 12 - DRIVERLESS 13 - NEGOTIATING A CURVE 14 - ENTERING OR CROSSING SPECIFIED LOCATION

15 - WALKING, RUNNING, JOGGING, PLAYING 16 - WORKING 17 - PUSHING VEHICLE 18 - APPROACHING OR LEAVING VEHICLE 19 - STANDING 20 - OTHER NON-MOTORIST

21 - STANDING OUTSIDE DISABLED VEHICLE 99 - OTHER / UNKNOWN

CONTRIBUTING CIRCUMSTANCES 1

1 - NONE 2 - FAILURE TO YIELD 3 - RAN RED LIGHT 4 - RAN STOP SIGN 5 - UNSAFE SPEED 6 - IMPROPER TURN 7 - LEFT OF CENTER

8 - FOLLOWING TOO CLOSE /ACDA 9 - IMPROPER LANE CHANGE 10 - IMPROPER PASSING 11 - DROVE OFF ROAD 12 - IMPROPER BACKING

13 - IMPROPER START FROM A PARKED POSITION 14 - STOPPED OR PARKED ILLEGALLY 15 - SWERVING TO AVOID 16 - WRONG WAY 17 - VISION OBSTRUCTION

18 - OPERATING DEFECTIVE EQUIPMENT 19 - LOAD SHIFTING /FALLING/SPILLING 20 - IMPROPER CROSSING 21 - LYING IN ROADWAY 22 - NOT DISCERNIBLE

23 - OPENING DOOR INTO ROADWAY 99 - OTHER IMPROPER ACTION

SEQUENCE OF EVENTS

1 20 1 - OVERTURN/ROLLOVER 2 - FIRE/EXPLOSION 3 - IMMERSION 4 - JACKKNIFE 5 - CARGO / EQUIPMENT LOSS OR SHIFT 6 - EQUIPMENT FAILURE

7 - SEPARATION OF UNITS 8 - RAN OFF ROAD RIGHT 9 - RAN OFF ROAD LEFT 10 - CROSS MEDIAN 11 - CROSS CENTERLINE - OPPOSITE DIRECTION OF TRAVEL

EVENTS

12 - DOWNHILL RUNAWAY 13 - OTHER NON-COLLISION 14 - PEDESTRIAN 15 - PEDALCYCLE 16 - RAILWAY VEHICLE 17 - ANIMAL - FARM 18 - ANIMAL - DEER

19 - ANIMAL - OTHER 20 - MOTOR VEHICLE IN TRANSPORT 21 - PARKED MOTOR VEHICLE 22 - WORK ZONE MAINTENANCE EQUIPMENT

23 - STRUCK BY FALLING, SHIFTING CARGO OR ANYTHING SET IN MOTION BY A MOTOR VEHICLE 24 - OTHER MOVABLE OBJECT

COLLISION WITH FIXED OBJECT - STRUCK

25 - IMPACT ATTENUATOR / CRASH CUSHION 26 - BRIDGE OVERHEAD STRUCTURE 27 - BRIDGE PIER OR ABUTMENT 28 - BRIDGE PARAPET 29 - BRIDGE RAIL 30 - GUARDRAIL FACE

31 - GUARDRAIL END 32 - PORTABLE BARRIER 33 - MEDIAN CABLE BARRIER 34 - MEDIAN GUARDRAIL BARRIER 35 - MEDIAN CONCRETE BARRIER 36 - MEDIAN OTHER BARRIER 37 - TRAFFIC SIGN POST

38 - OVERHEAD SIGN POST 39 - LIGHT / LUMINARIES SUPPORT 40 - UTILITY POLE 41 - OTHER POST, POLE OR SUPPORT 42 - CULVERT 43 - CURB 44 - DITCH

45 - EMBANKMENT 46 - FENCE 47 - MAILBOX 48 - TREE 49 - FIRE HYDRANT 50 - WORK ZONE MAINTENANCE EQUIPMENT 51 - WALL

52 - BUILDING 53 - TUNNEL 54 - OTHER FIXED OBJECT 99 - OTHER / UNKNOWN

FIRST HARMFUL EVENT 1 MOST HARMFUL EVENT 1

LOCAL REPORT NUMBER

25-OPD-0352

DAMAGE

DAMAGE SCALE

1 - NONE 2 - MINOR DAMAGE 3 - FUNCTIONAL DAMAGE 4 - DISABLING DAMAGE 9 - UNKNOWN

2

DAMAGED AREA(S)

INDICATE ALL THAT APPLY

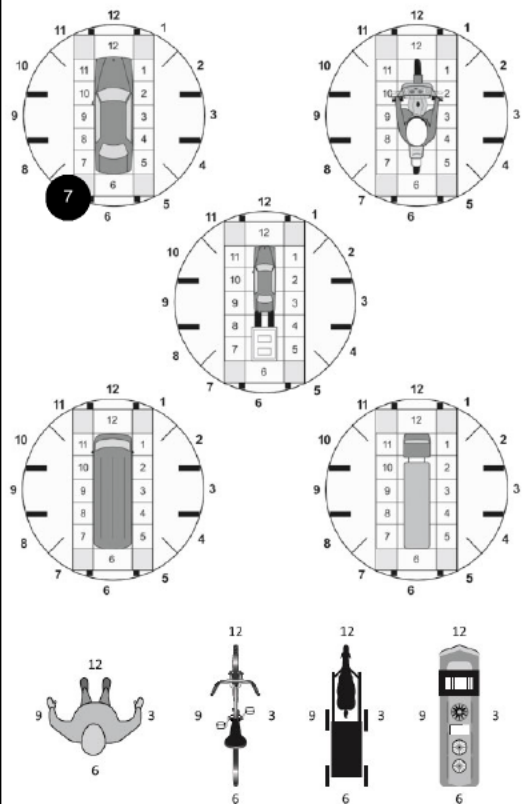

NO DAMAGE [0] UNDERCARRIAGE [14]

TOP [13] ALL AREAS [15]

UNIT NOT AT SCENE [16]

INITIAL POINT OF CONTACT

0 - NO DAMAGE 14 - UNDERCARRIAGE

1-12 - REFER TO UNIT DIAGRAM 15 - VEHICLE NOT AT SCENE 99 - UNKNOWN

7

13 - TOP

TRAFFIC

TRAFFICWAY FLOW 1

1 - ONE-WAY 2 - TWO-WAY

TRAFFIC CONTROL 6

1 - ROUNDABOUT 2 - SIGNAL 3 - FLASHER 4 - STOP SIGN 5 - YIELD SIGN 6 - NO CONTROL

OF THROUGH LANES ON ROAD 1

RAIL GRADE CROSSING 1

1 - NOT INVOLVED 2 - INVOLVED-ACTIVE CROSSING 3 - INVOLVED-PASSIVE CROSSING

UNIT / NON-MOTORIST DIRECTION

FROM 9 TO 9

1 - NORTH 2 - SOUTH 3 - EAST 4 - WEST 5 - NORTHEAST 6 - NORTHWEST 7 - SOUTHEAST 8 - SOUTHWEST 9 - OTHER / UNKNOWN

UNIT SPEED

0

DETECTED SPEED

1 - STATED / ESTIMATED SPEED

1 2 - CALCULATED / EDR

3 - UNDETERMINED

POSTED SPEED

MOTORIST / Non-MOTORIST

LOCAL REPORT NUMBER
25-OPD-0352

UNIT # 1	NAME: LAST, FIRST, MIDDLE BRUNS, ANNA, L				DATE OF BIRTH 04/08/1982		AGE 43	GENDER F			
ADDRESS: STREET, CITY, STATE, ZIP 9106 RAYMODN RD , BROOKVILLE, IN, 470128116					CONTACT PHONE - INCLUDE AREA CODE [REDACTED]						
INJURIES 5	INJURED TAKEN BY [REDACTED]	EMS AGENCY (NAME)	INJURED TAKEN TO: MEDICAL FACILITY (NAME, CITY)		SAFETY EQUIPMENT USED 99	<input type="checkbox"/> DOT-COMPLIANT <input checked="" type="checkbox"/> MC HELMET	SEATING POSITION 1	AIR BAG USAGE 1	EJECTION 1	TRAPPED 1	
OL STATE [REDACTED]	OPERATOR LICENSE NUMBER [REDACTED]		OFFENSE CHARGED 4549.021		LOCAL CODE <input type="checkbox"/>	OFFENSE DESCRIPTION STOPPING AFTER ACCIDENT INVOLVI			CITATION NUMBER 392856		
OL CLASS 4	ENDORSEMENT	RESTRICTION SELECT UP TO 3		DRIVER DISTRACTED BY	ALCOHOL / DRUG SUSPECTED <input type="checkbox"/> ALCOHOL <input type="checkbox"/> MARIJUANA <input type="checkbox"/> OTHER DRUG		CONDITION 3	ALCOHOL TEST		DRUG TEST(S)	
						STATUS 1	TYPE 1	VALUE	STATUS 1	TYPE 1	RESULTS SELECT UP TO 4

UNIT #	NAME: LAST, FIRST, MIDDLE				DATE OF BIRTH		AGE	GENDER			
ADDRESS: STREET, CITY, STATE, ZIP					CONTACT PHONE - INCLUDE AREA CODE						
INJURIES	INJURED TAKEN BY	EMS AGENCY (NAME)	INJURED TAKEN TO: MEDICAL FACILITY (NAME, CITY)		SAFETY EQUIPMENT USED	<input type="checkbox"/> DOT-COMPLIANT <input type="checkbox"/> MC HELMET	SEATING POSITION	AIR BAG USAGE	EJECTION	TRAPPED	
OL STATE	OPERATOR LICENSE NUMBER		OFFENSE CHARGED		LOCAL CODE	OFFENSE DESCRIPTION			CITATION NUMBER		
OL CLASS	ENDORSEMENT	RESTRICTION SELECT UP TO 3		DRIVER DISTRACTED BY	ALCOHOL / DRUG SUSPECTED <input type="checkbox"/> ALCOHOL <input type="checkbox"/> MARIJUANA <input type="checkbox"/> OTHER DRUG		CONDITION	ALCOHOL TEST		DRUG TEST(S)	
						STATUS	TYPE	VALUE	STATUS	TYPE	RESULTS SELECT UP TO 4

UNIT #	NAME: LAST, FIRST, MIDDLE				DATE OF BIRTH		AGE	GENDER			
ADDRESS: STREET, CITY, STATE, ZIP					CONTACT PHONE - INCLUDE AREA CODE						
INJURIES	INJURED TAKEN BY	EMS AGENCY (NAME)	INJURED TAKEN TO: MEDICAL FACILITY (NAME, CITY)		SAFETY EQUIPMENT USED	<input type="checkbox"/> DOT-COMPLIANT <input type="checkbox"/> MC HELMET	SEATING POSITION	AIR BAG USAGE	EJECTION	TRAPPED	
OL STATE	OPERATOR LICENSE NUMBER		OFFENSE CHARGED		LOCAL CODE	OFFENSE DESCRIPTION			CITATION NUMBER		
OL CLASS	ENDORSEMENT	RESTRICTION SELECT UP TO 3		DRIVER DISTRACTED BY	ALCOHOL / DRUG SUSPECTED <input type="checkbox"/> ALCOHOL <input type="checkbox"/> MARIJUANA <input type="checkbox"/> OTHER DRUG		CONDITION	ALCOHOL TEST		DRUG TEST(S)	
						STATUS	TYPE	VALUE	STATUS	TYPE	RESULTS SELECT UP TO 4

INJURIES	SEATING POSITION	AIR BAG	OL CLASS	OL RESTRICTION(S)	DRIVER DISTRACTION	TEST STATUS
1 - FATAL 2 - SUSPECTED SERIOUS INJURY 3 - SUSPECTED MINOR INJURY 4 - POSSIBLE INJURY 5 - NO APPARENT INJURY	1 - FRONT - LEFT SIDE (MOTORCYCLE DRIVER) 2 - FRONT - MIDDLE 3 - FRONT - RIGHT SIDE (MOTORCYCLE PASSENGER) 4 - SECOND - LEFT SIDE 5 - SECOND - MIDDLE 6 - SECOND - RIGHT SIDE 7 - THIRD - LEFT SIDE (MOTORCYCLE SIDE CAR) 8 - THIRD - MIDDLE 9 - THIRD - RIGHT SIDE 10 - SLEEPER SECTION OF TRUCK CAB 11 - PASSENGER IN OTHER ENCLOSED CARGO AREA (NON-TRAILING UNIT, BUS, PICK-UP WITH CAP) 12 - PASSENGER IN UNENCLOSED CARGO AREA 13 - TRAILING UNIT 14 - RIDING ON VEHICLE EXTERIOR (NON-TRAILING UNIT) 15 - NON-MOTORIST 99 - OTHER / UNKNOWN	1 - NOT DEPLOYED 2 - DEPLOYED FRONT 3 - DEPLOYED SIDE 4 - DEPLOYED BOTH FRONT/SIDE 5 - NOT APPLICABLE 9 - DEPLOYMENT UNKNOWN	1 - CLASS A 2 - CLASS B 3 - CLASS C 4 - REGULAR CLASS (OHIO = D) 5 - M/C MOPEO ONLY 6 - NO VALID OL	1 - ALCOHOL INTERLOCK DEVICE 2 - CDL INTRASTATE ONLY 3 - CORRECTIVE LENSES 4 - FARM WAIVER 5 - EXCEPT CLASS A BUS & CLASS B BUS 6 - EXCEPT CLASS A & CLASS B BUS 7 - EXCEPT TRACTOR-TRAILER 8 - INTERMEDIATE LICENSE RESTRICTIONS 9 - LEARNER'S PERMIT RESTRICTIONS 10 - LIMITED TO DAYLIGHT ONLY 11 - LIMITED TO EMPLOYMENT 12 - LIMITED - OTHER 13 - MECHANICAL DEVICES (SPECIAL BRAKES, HAND CONTROLS, OR OTHER ADAPTIVE DEVICES) 14 - MILITARY VEHICLES ONLY 15 - MOTOR VEHICLES WITHOUT AIR BRAKES 16 - OUTSIDE MIRROR 17 - PROSTHETIC AID 18 - OTHER	1 - NOT DISTRACTED 2 - MANUALLY OPERATING AN ELECTRONIC COMMUNICATION DEVICE (TEXTING, TYPING, DIALING) 3 - TALKING ON HANDS-FREE COMMUNICATION DEVICE 4 - TALKING ON HAND-HELD COMMUNICATION DEVICE 5 - OTHER ACTIVITY WITH AN ELECTRONIC DEVICE 6 - PASSENGER 7 - OTHER DISTRACTION INSIDE THE VEHICLE 8 - OTHER DISTRACTION OUTSIDE THE VEHICLE 9 - OTHER / UNKNOWN	1 - NONE GIVEN 2 - TEST REFUSED 3 - TEST GIVEN, CONTAMINATED SAMPLE / UNUSABLE 4 - TEST GIVEN, RESULTS KNOWN 5 - TEST GIVEN, RESULTS UNKNOWN
INJURIES TAKEN BY		EJECTION	OL ENDORSEMENT		CONDITION	ALCOHOL TEST TYPE
1 - NOT TRANSPORTED /TREATED AT SCENE 2 - EMS 3 - POLICE 9 - OTHER / UNKNOWN		1 - NOT EJECTED 2 - PARTIALLY EJECTED 3 - TOTALLY EJECTED 4 - NOT APPLICABLE	H - HAZMAT M - MOTORCYCLE P - PASSENGER N - TANKER Q - MOTOR SCOOTER R - THREE-WHEEL MOTORCYCLE S - SCHOOL BUS T - DOUBLE & TRIPLE TRAILERS X - TANKER / HAZMAT		1 - APPARENTLY NORMAL 2 - PHYSICAL IMPAIRMENT 3 - EMOTIONAL (E.G., DEPRESSED, ANGRY, DISTURBED) 4 - ILLNESS 5 - FELL ASLEEP, FAINTED, FATIGUED, ETC. 6 - UNDER THE INFLUENCE OF MEDICATIONS / DRUGS / ALCOHOL 9 - OTHER / UNKNOWN	1 - NONE 2 - BLOOD 3 - URINE 4 - BREATH 5 - OTHER
SAFETY EQUIPMENT		TRAPPED	GENDER			DRUG TEST TYPE
1 - NONE USED 2 - SHOULDER BELT ONLY USED 3 - LAP BELT ONLY USED 4 - SHOULDER & LAP BELT USED 5 - CHILD RESTRAINT SYSTEM - FORWARD FACING 6 - CHILD RESTRAINT SYSTEM - REAR FACING 7 - BOOSTER SEAT 8 - HELMET USED 9 - PROTECTIVE PADS USED (ELBOWS, KNEES, ETC) 10 - REFLECTIVE CLOTHING 11 - LIGHTING - PEDESTRIAN / BICYCLE ONLY 99 - OTHER / UNKNOWN		1 - NOT TRAPPED 2 - EXTRICATED BY MECHANICAL MEANS 3 - FREED BY NON-MECHANICAL MEANS	F - FEMALE M - MALE U - OTHER / UNKNOWN			DRUG TEST RESULT(S)
						1 - AMPHETAMINES 2 - BARBITURATES 3 - BENZODIAZEPINES 4 - CANNABINOIDS 5 - COCAINE 6 - OPIATES / OPIOIDS 7 - OTHER 8 - NEGATIVE RESULTS

OCCUPANT / WITNESS ADDENDUM

LOCAL REPORT NUMBER
25-OPD-0352

OCCUPANT	UNIT #	NAME: LAST, FIRST, MIDDLE			DATE OF BIRTH		AGE	GENDER	
	ADDRESS: STREET, CITY, STATE, ZIP				CONTACT PHONE - INCLUDE AREA CODE				
INJURIES	INJURED TAKEN BY	EMS AGENCY (NAME)	INJURED TAKEN TO: MEDICAL FACILITY (NAME, CITY)	SAFETY EQUIPMENT	<input type="checkbox"/> DOT-COMPLIANT MC HELMET	SEATING POSITION	AIR BAG USAGE	EJECTION	TRAPPED
UNIT #	NAME: LAST, FIRST, MIDDLE			DATE OF BIRTH		AGE	GENDER		
ADDRESS: STREET, CITY, STATE, ZIP				CONTACT PHONE - INCLUDE AREA CODE					
INJURIES	INJURED TAKEN BY	EMS AGENCY (NAME)	INJURED TAKEN TO: MEDICAL FACILITY (NAME, CITY)	SAFETY EQUIPMENT	<input type="checkbox"/> DOT-COMPLIANT MC HELMET	SEATING POSITION	AIR BAG USAGE	EJECTION	TRAPPED
UNIT #	NAME: LAST, FIRST, MIDDLE			DATE OF BIRTH		AGE	GENDER		
ADDRESS: STREET, CITY, STATE, ZIP				CONTACT PHONE - INCLUDE AREA CODE					
INJURIES	INJURED TAKEN BY	EMS AGENCY (NAME)	INJURED TAKEN TO: MEDICAL FACILITY (NAME, CITY)	SAFETY EQUIPMENT	<input type="checkbox"/> DOT-COMPLIANT MC HELMET	SEATING POSITION	AIR BAG USAGE	EJECTION	TRAPPED
UNIT #	NAME: LAST, FIRST, MIDDLE			DATE OF BIRTH		AGE	GENDER		
ADDRESS: STREET, CITY, STATE, ZIP				CONTACT PHONE - INCLUDE AREA CODE					
INJURIES	INJURED TAKEN BY	EMS AGENCY (NAME)	INJURED TAKEN TO: MEDICAL FACILITY (NAME, CITY)	SAFETY EQUIPMENT	<input type="checkbox"/> DOT-COMPLIANT MC HELMET	SEATING POSITION	AIR BAG USAGE	EJECTION	TRAPPED

INJURIES	SAFETY EQUIPMENT USED	SEATING POSITION	AIR BAG USAGE
1 - FATAL 2 - SUSPECTED SERIOUS INJURY 3 - SUSPECTED MINOR INJURY 4 - POSSIBLE INJURY 5 - NO APPARENT INJURY	1 - NONE USED - VEHICLE OCCUPANT 2 - SHOULDER BELT ONLY USED 3 - LAP BELT ONLY USED 4 - SHOULDER & LAP BELT USED 5 - CHILD RESTRAINT SYSTEM - FORWARD FACING 6 - CHILD RESTRAINT SYSTEM - REAR FACING 7 - BOOSTER SEAT 8 - HELMET USED 9 - PROTECTIVE PADS USED (ELBOWS, KNEES, ETC) 10 - REFLECTIVE CLOTHING 11 - LIGHTING - PEDESTRIAN / BICYCLE ONLY 99 - OTHER / UNKNOWN	1 - FRONT - LEFT SIDE (MOTORCYCLE DRIVER) 2 - FRONT - MIDDLE 3 - FRONT - RIGHT SIDE 4 - SECOND - LEFT SIDE (MOTORCYCLE PASSENGER) 5 - SECOND - MIDDLE 6 - SECOND - RIGHT SIDE 7 - THIRD - LEFT SIDE (MOTORCYCLE SIDE CAR) 8 - THIRD - MIDDLE 9 - THIRD - RIGHT SIDE 10 - SLEEPER SECTION OF TRUCK CAB 11 - PASSENGER IN OTHER ENCLOSED CARGO AREA (NON-TRAILING UNIT SUCH AS A BUS, PICK-UP WITH CAP) 12 - PASSENGER IN UNENCLOSED CARGO AREA 13 - TRAILING UNIT 14 - RIDING ON VEHICLE EXTERIOR (NON-TRAILING UNIT) 15 - NON-MOTORIST 99 - OTHER / UNKNOWN	1 - NOT DEPLOYED 2 - DEPLOYED FRONT 3 - DEPLOYED SIDE 4 - DEPLOYED BOTH FRONT/SIDE 5 - NOT APPLICABLE 9 - DEPLOYMENT UNKNOWN
INJURED TAKEN BY			EJECTION
1 - NOT TRANSPORTED / TREATED AT SCENE 2 - EMS 3 - POLICE 9 - OTHER / UNKNOWN			1 - NOT EJECTED 2 - PARTIALLY EJECTED 3 - TOTALLY EJECTED 4 - NOT APPLICABLE
GENDER			TRAPPED
F - FEMALE M - MALE U - OTHER / UNKNOWN			1 - NOT TRAPPED 2 - EXTRICATED BY MECHANICAL MEANS 3 - FREED BY NON-MECHANICAL MEANS

WITNESS	NAME: LAST, FIRST, MIDDLE STERMS, MICHAEL	DATE OF BIRTH 10/23/1982		AGE 42	GENDER M
	ADDRESS: STREET, CITY, STATE, ZIP 300 LIBERTY AVE, WEST COLLEGE CORNER, IN, 470039357		CONTACT PHONE - INCLUDE AREA CODE		
WITNESS	NAME: LAST, FIRST, MIDDLE	DATE OF BIRTH		AGE	GENDER
	ADDRESS: STREET, CITY, STATE, ZIP		CONTACT PHONE - INCLUDE AREA CODE		
WITNESS	NAME: LAST, FIRST, MIDDLE	DATE OF BIRTH		AGE	GENDER
	ADDRESS: STREET, CITY, STATE, ZIP		CONTACT PHONE - INCLUDE AREA CODE		